

963 Industrial Road, Suite F SAN CARLOS BUSINESS PARK

FOR LEASE

± 2,622 SF Office / Warehouse



- ± 1,500 sq.ft. of Warehouse Space
- ± 1,122 sq.ft. of HVAC Office Space
- Two (2) Grade Level Doors
- Highway 101 Frontage with High Visibility
- Professional Business Park Setting
- Immediate Access to Highway 101
- Building and Monument Signage
- Close Vicinity to Popular Local Amenities
- Flexible Lease Terms
- \$1.20/sq.ft./mo. NNN



Contact Information:

Robert McSweeney
Senior Vice President
Bob.McSweeney@cbre.com
650.577.2928

Jose Bustamante
Senior Associate
Jose.Bustamante@cbre.com
650.577.2914

963 Industrial Road, Suite F SAN CARLOS BUSINESS PARK

FOR LEASE

± 2,622 SF Office / Warehouse

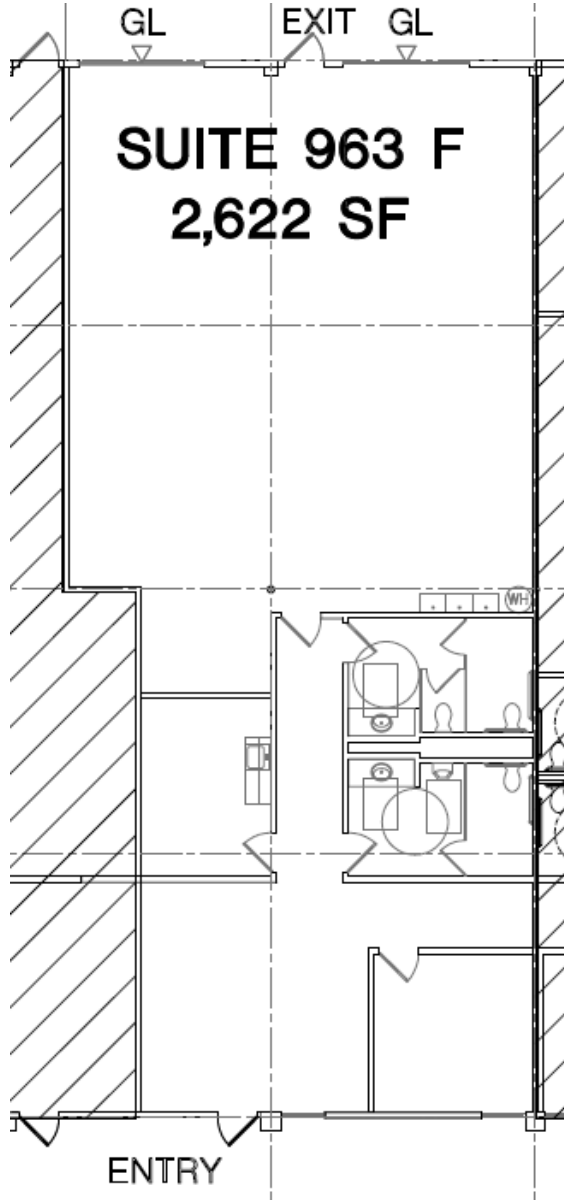

NOT TO SCALE



© 2009 CB Richard Ellis, Inc. We obtained the information above from sources we believe to be reliable. However, we have not verified its accuracy and make no guarantee, warranty or representation about it. It is submitted subject to the possibility of errors, omissions, change of price, rental or other conditions, prior sale, lease or financing, or withdrawal without notice. We include projections, opinions, assumptions or estimates for example only, and they may not represent current or future performance of the property. You and your tax and legal advisors should conduct your own investigation of the property and transaction.