

# 969 Industrial Road, Suite I SAN CARLOS BUSINESS PARK

## FOR LEASE

### ± 1,604 SF Office / Warehouse



- ±1,604 SQ FT of Warehouse Space
- One (1) Grade Level Door
- Highway 101 Frontage with High Visibility
- Professional Business Park Setting
- Immediate Access to Highway 101
- Building Signage Available
- Close Vicinity to Popular Local Amenities
- Flexible Lease Term
- \$1.20/SF/mo. NNN

CB Richard Ellis, Inc.  
Broker Lic. 00409987

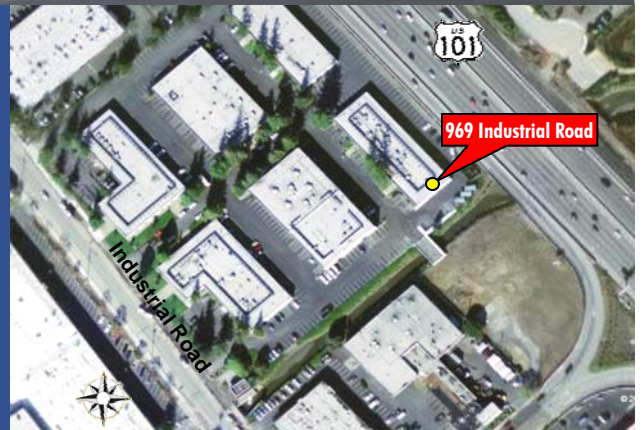

#### Contact Information:

**Robert McSweeney**

Senior Vice President

Lic. 00934240

650.577.2928

Bob.McSweeney@cbre.com

**David Wright**

Senior Associate

Lic. 01839331

650.577.2908

C.David.Wright@cbre.com

**Ryan Walsh**

Associate

Lic. 01853815

T.650.577.2943

Ryan.Walsh@cbre.com

**CBRE**  
CB RICHARD ELLIS

LOCALLY OWNED AND MANAGED BY  
**Black Mountain**  
PROPERTIES, LLC

# 969 Industrial Road, Suite I SAN CARLOS BUSINESS PARK

## FOR LEASE

### ± 1,604 SF Office / Warehouse

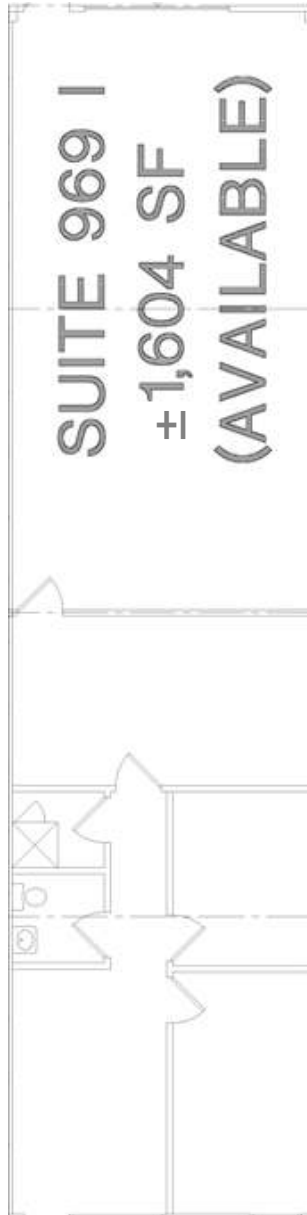

NOT TO SCALE

© 2009 CB Richard Ellis, Inc. This information has been obtained from sources believed reliable. We have not verified it and make no guarantee, warranty or representation about it. Any projections, opinions, assumptions or estimates used are for example only and do not represent the current or future performance of the property. You and your advisors should conduct a careful, independent investigation of the property to determine to your satisfaction the suitability of the property for your needs.